

eyebase V5

The Digital Asset Management application of the future.

Working with the web-based platform allows you to remotely work on centralized data.

Data is accessible to all employees via an intuitive and userfriendly, yet highly customisable user frontend. Uploading, downloading or directly using in other software applications and especially efficient metadata editing offers a new perspective.

eyebase is a companion of all media assets over their entire life cycle. From creating it, using it until archiving the assets eyebase supports daily routines and makes working with assets time efficient.

First installation: 2006

Provider

CMB Informationssysteme GmbH
Pfaffendorfstrasse 5c
DE-83454 Anger
+49 (0) 81 52/929 096-0
contact@eyebase.com
www.eyebase.com

Updated on: 2022-02-22

Picture gallery

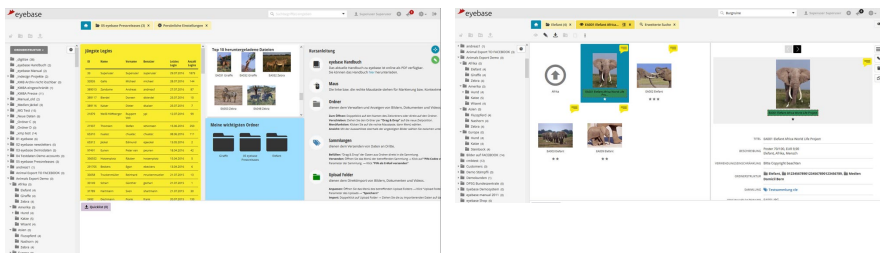

Reference customers

BMW AG Munich, Haribo, Malteser Hilfsdienst, ÖAMTC, CHANEL, Hotelleriesuisse, Contitec AG, Graupner, Smith & Nephew, Giroflex, Swisspower Holding, Familotel, Rieker, Pentel, Stadler Rail, Vorarlberg Tourism Agency

Application

- ✓ Business-to-Business
- ✓ Business-to-Consumer
- ✗ Consumer-to-Consumer

Operator

- ✓ Media service providers
- ✓ Companies
- ✓ Publishers

Integrations

- ✓ Standard API
- ✓ Converter
- ✓ Connector, Plug-in
- ✓ Data Hub

Products

- | | | |
|--|---------------------------|----------------------------------|
| ✓ Advertising material, office equipment | ✗ Books, teaching aids | ✗ Mercandises, promotional items |
| ✗ Large formats | ✓ Catalogues, price lists | ✓ Packaging |
| ✗ Newspapers, magazines | ✗ Technical documentation | |

Media channels (internal / external)

- | | | |
|----------------------|------------------|-------------------------|
| ✓ ✓ Print | ✗ ✗ Apps | ✗ ✗ Messenger |
| ✓ ✓ Website, webshop | ✗ ✗ E-books | ✓ ✓ Office applications |
| ✗ ✓ Online, Mobile | ✓ ✓ Video/Audio | ✓ ✓ Search engines |
| ✗ ✗ Out-of-Home | ✗ ✓ E-mail | ✓ ✓ Online marketplaces |
| ✓ ✗ E-paper | ✓ ✓ Social media | |

Features

✓ Closed shop	✓ Database publishing	✗ Editorial system
✓ Open shop	✓ Online data check	✓ Translation management
✓ E-shop in-house development	✓ Correction workflow	✓ Marketing management
✗ E-shop standard system	✓ Technical workflow	✗ Media planning, media booking
✓ Printed file upload	✓ Commercial workflow	✗ Customer relationship management
✓ Print on demand	✓ Media asset management	✓ Cross-media management
✓ Individualisation	✓ Product information management	✓ Content marketing management
✗ Personalisation	✗ Web content management	✓ Communication
✓ Creation of publications	✗ Text database	

Modules

Adobe and MS Office Connectivity

eyebase is directly integrated in Adobe and MS Office products. Using the CI-HUB Connector also many other systems are directly supported

eyeSync

eyeSync is an alternative or enhancement of the Dropbox. A lokal folder on the harddisk can be synchronised with media managed in eyebase.

eyebase API

A simple to use and well documented API allows integration of third party systems.

YouTube Plugin

eyebase collects, downloads and manages videos from defined video platform sources. Your own Youtube channel can also be fully managed using eyebase.

Brand Portal / Presenter App

Feed content from eyebase to your brand portal automatically. Your target audience, internal staff, external people, journalists, partners all get the information they need.

PIM / Produkt Information Management

eyebase collects PIM data from ERP systems and enriches it with configurable metadata. PIM Data is smartly connected with all kinds of product related media files.

System basis

Frontend devices	Browser based
Frontend operating systems	all
Frontend web browsers	all
Frontend technology	HTML5
Server operation systems	Windows, Linux, VM
Server technology	
Webserver	Apache, MS Internet Information Service (IIS)
PDF engine	own
Database system	MS SQL, MySQL
Operating	On provider server or On customer server

Interfaces

Pre-press and printing	all
Order systems	
Databases	MS SQL, MySQL
Other	The eyebase API allows to connect any third party system easily

Licence models

Costs for system setup	depends on project
Buying license	✓ eyebase is available on a "named user" license basis or as a "concurrent user" license model. Starting at 2890,00 EUR
Rental license	✓ Starting at 780,00 EUR one time and 50,00 EUR monthly

CMB Informationssysteme GmbH

CMB builds Digital Asset Management systems since 1995 and markets its latest development eyebase since 2006

Provider information

Founding year	1995
Total number of employees	13
Number of employees in Germany, Austria and Switzerland	11
Locations	Anger / Germany Wien / Austria New York City / USA
Industry specialisation	
Certificates	

Systems and services

eyebase V5